

# ALU-STEEL

European - Groove  
Thermally broken

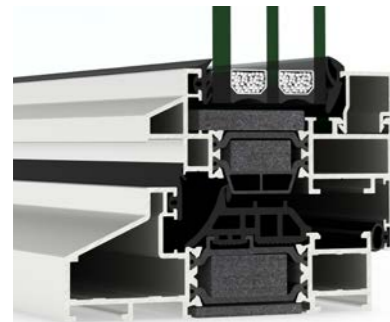

Inspired by classic line designs, the new Alu-Steel system allows to combine aluminium outstanding performances values with a steel-alike appearance. With a sightline of only 72.5 mm, Alu-Steel is the perfect solution for new buildings and refurbishments, offering two different versions, classic or modern.



\*Classic version



\*Modern version

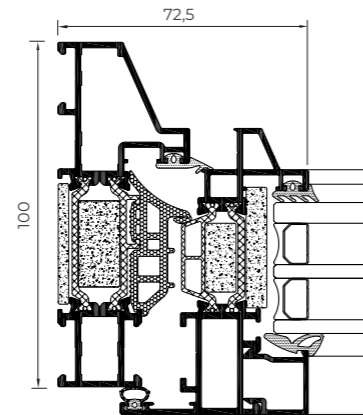

\*Classic version

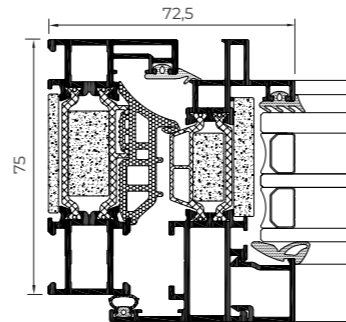

\*Modern version

## POSSIBILITIES



SECURITY  
HARDWARE



CONCEALED  
HINGES



CONCEALED  
HANDLE

## OPENING POSSIBILITIES



Inward Opening

Side hung  
Tilt & turn  
Tilt only

## FEATURES

Transmittance		$U_w \geq 0.83 (W/m^2K)$
Air permeability		Class 4
Water tightness		Class E1200
Wind resistance		Class C5

Reference test 1.23 x 1.48 m / 2 sashes

## ALU-STEEL



## Sightlines

Modern frame 75 mm  
Classic frame 100 mm  
Sash 83 mm

## Polyamide Strip Length

32-39 mm

## Profile Thickness

Window 1,5 mm

## Glazing

Max. 54 mm, Min. 20 mm

## Maximum Sash Dimensions

Width (L) 1500 mm, Height (H) 2600 mm

## Maximum Sash Weight

160 kg

Consult maximum weight and dimensions according to typologies